

# OVERSEAS

"TB-TBA"

**MANUAL**

KEEPING AHEAD OF THE CUTTING EDGE™



## MODEL TB - TBA SERIES SNOW PLOWS

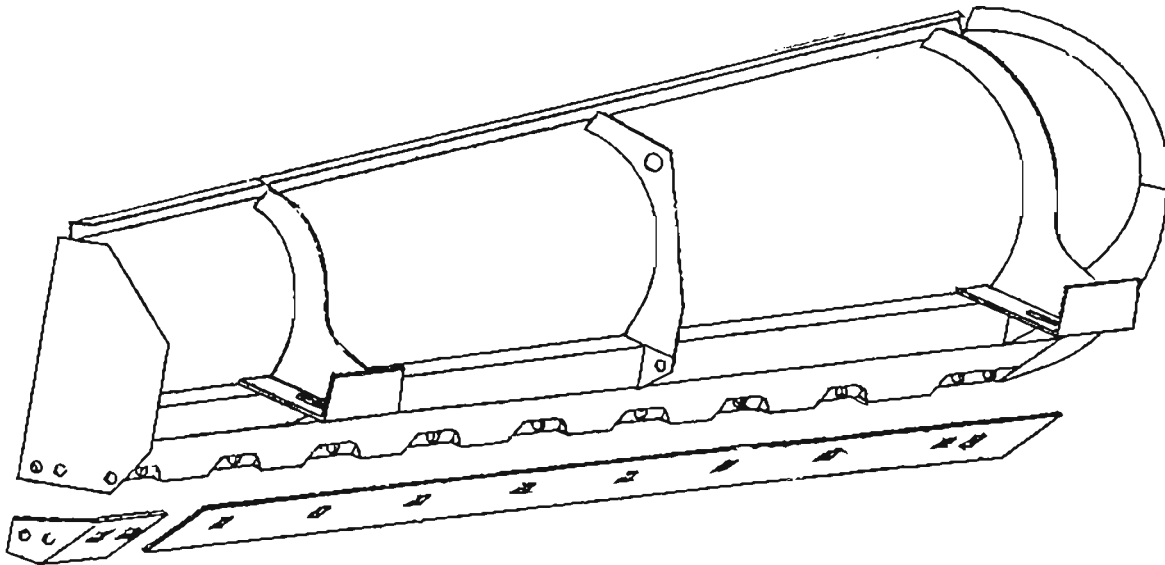

SCHMIDT ENGINEERING & EQUIPMENT, INC.  
1905 SOUTH MOORLAND ROAD NEW BERLIN, WISCONSIN 53151 U.S.A.  
PHONE: (414) 784-6066 PARTS FAX NO. (414) 784-1395

## TABLE OF CONTENTS

1. SAFETY INSTRUCTIONS
2. SERVICE PROCEDURES
3. INSTALLATION INSTRUCTIONS
4. OPERATION
5. PARTS LIST
6. TORQUE SPECIFICATION
7. WARRANTY

## 1. SAFETY INSTRUCTIONS

***BEFORE OPERATING WAUSAU SNOW REMOVAL EQUIPMENT, THESE INSTRUCTIONS MUST BE READ COMPLETELY! FAILURE TO FOLLOW THESE INSTRUCTIONS COULD BE HAZARDOUS TO THE SAFETY OF THE OPERATORS AND PERSONNEL.***

MODIFICATIONS MADE TO THIS EQUIPMENT WITHOUT THE WRITTEN CONSENT OF SCHMIDT ENGINEERING AND EQUIPMENT, INC. WILL VOID WARRANTY AND WILL RELEASE SCHMIDT ENGINEERING AND EQUIPMENT, INC. FROM ANY LIABILITIES.

WHEN WORKING ON THIS EQUIPMENT FOR MAINTENANCE, ADJUSTMENTS OR HYDRAULIC WORK, MAKE SURE EQUIPMENT IS LOWERED AND RESTING ON A LEVEL FLOOR. WHEN EQUIPMENT HAS TO BE RAISED TO PERFORM MAINTENANCE WORK, EQUIPMENT SUCH AS BLOWERS, PLOWS, BROOMS, DRIVE FRAMES, ETC., SHOULD BE SUPPORTED BY A SOLID STRUCTURE RESTING ON A SOLID LEVEL FLOOR.

WHEN EQUIPMENT IS READY TO BE RAISED, LOWERED OR REVERSED, MAKE SURE TO  
**S T A N D C L E A R !**

1. **SAFETY INSTRUCTIONS** (continued)

**AVOID ACCIDENTS**

Most accidents, whether they occur in industry, on the farm, at home or on the highway, are caused by the failure of some individual to following simple and fundamental safety rules or precautions. For this reason, most accidents can be prevented by recognizing the real cause and doing something about it before the accident occurs.

Regardless of the care used in the design and construction of any type of equipment, there are many conditions that cannot be completely safeguarded against without interfering with reasonable accessibility and efficient operation.

A careful operator is the best insurance against an accident. The complete observance of one simple rule would prevent many thousand serious injuries each year. That rule is:

**NEVER ATTEMPT TO CLEAN, OIL OR ADJUST A MACHINE WHILE IT IS IN MOTION.**

NATIONAL SAFETY COUNCIL

**IMPORTANT**

When purchasing parts or giving instructions for repairs, customers should, in their own best interests, always specify:

**GENUINE SCHMIDT/WAUSAU PARTS**

Parts that have not been supplied by the Schmidt organization cannot be relied upon for correct material, dimensions or finish.

SCHMIDT ENGINEERING AND EQUIPMENT, INC. cannot therefore, be responsible for any damage arising from the use of such parts and the guarantee will be invalidated.

In your own best interest, therefore, specify:

**GENUINE SCHMIDT/WAUSAU PARTS**

## **2. SERVICE PROCEDURES**

### **2.1 INITIAL SERVICE PROCEDURE**

1. Check bolts for tightness. Torque loose bolts to the limits set forth in the torque specifications listed in this book.
2. Check that all pins are equipped with a keeper.
3. Adjust lifting devices for desired plow action.
4. Grease all fittings and exposed threads on adjusting screws.
5. Inspect all hydraulic hoses for possible chaffing or pinching.
6. Inspect all fittings for signs of leakage.
7. Ensure both hydraulic quick coupler halves are free of contamination before coupling.

### **2.2 SERVICE PROCEDURE 8 - 10 HOURS**

1. Grease all fittings and coat adjusting rods with grease.
2. Spray lubricant on all pivot points on the plow, i.e. moldboard pivot pins.
3. Check all bolts for looseness or breakage.
4. Inspect hydraulic components for damage or leaks.
5. Replace cutting edge if worn within 1/2 to 3/8 inches from the moldboard.
6. Replace skid shoes if the average thickness is 1/4 inch.
7. Check hitch locking mechanism to ensure plow is secure.
8. Inspect curb shoes for wear, replace if necessary.

### **2.3 ANNUAL SERVICE PROCEDURE**

1. Protect exposed cylinder rods with a thin film of grease during storage.
2. Cover all quick couplers with the appropriate plugs and caps.
3. Prime and paint all exposed metal surfaces.
4. Store the plow off of the ground on cribbing, if possible.
5. Drain the hydraulic system and change the filter every 500 hours or annually.

### 3. INSTALLATION - LEVEL LIFT KIT-PARTS

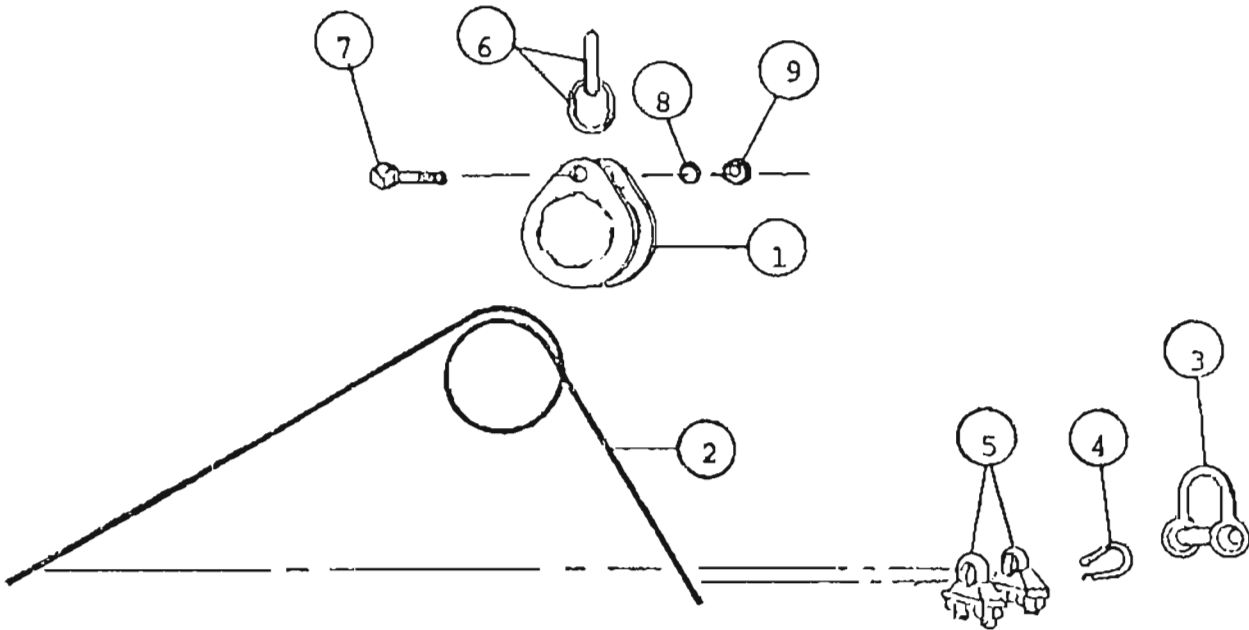

#### INSTALLATION INSTRUCTIONS:

To install level lift kit, take cable 2, and anchor to reverse frame of plow with Items 3, 4, and 5. Connect Item 1 to Item 6 with Item 7, 8, and 9, and install on hitch lift arm with pin on arm, through Item 6 link. Take cable and thread around Item 1 making loop as shown, and anchoring to opposite end of reverse frame of plow with Items 3, 4, and 5 making sure cable is loose on level lift so plow can float with road contour.

ITEM	NO. PER UNIT	PART NUMBER	DESCRIPTION
1	1	4W-02125	LEVEL LIFT WELDMENT
2	1	9C-01370-168	CABLE
3	2	9C-01407	STEEL SHACKLE
4	2	9C-01282	CABLE THIMBLE
5	4	9C-0127 6	CABLE CLIP
6	2	9C-00007	OPEN LINK
7	1	9C-01205	BOLT
8	1	9C-00096	NUT
9	1	9C-00139	LOCKWASHER

## **4. OPERATION**

### **4.1 GENERAL INSTRUCTIONS**

1. Do not attack a snow bank or a furrow of snow at highway speeds. Always reduce ground speed when applying a load to the plow.
  
2. Adjust plowing speeds to existing road conditions,  
i.e. the more severe the road surface, the slower the plowing speed must be.
  
3. Never alter or defeat factory adjustments or materials in any safety device,  
i.e. trip spring adjustment, shear bolt size, cushion valve adjustment.



# "R" SERIES & "TBA" SERIES PUSH FRAMES HAND ADJUSTABLE & DOUBLE RAM REVERSE

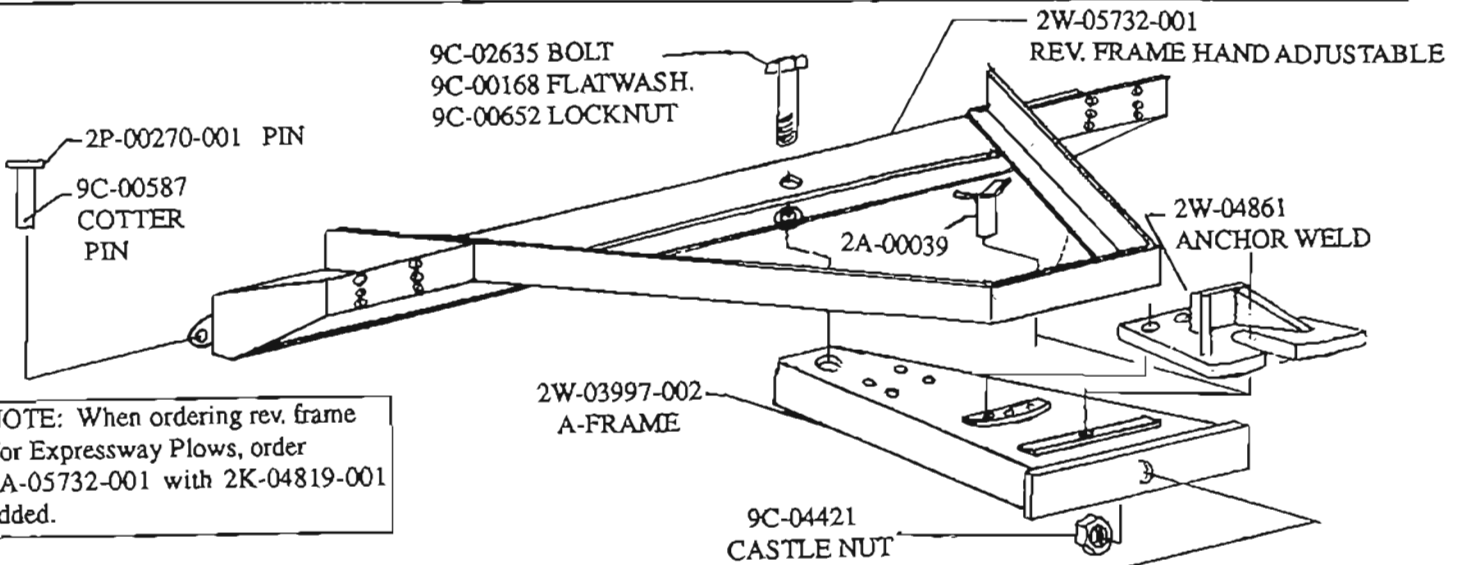

NOTE: When ordering rev. frame for Expressway Plows, order 2A-05732-001 with 2K-04819-001 added.

OSC. WELDMENTS		
PART NO.	WIDTH	
W2W07195	30	STD.
2K-04020	23	OPT.

PUSH PLATES		
PART NO.	LENGTH	
2P-01048	8	OPT.
2P-01052	13-1/2	STD.
2P-03147	23-1/2	OPT.

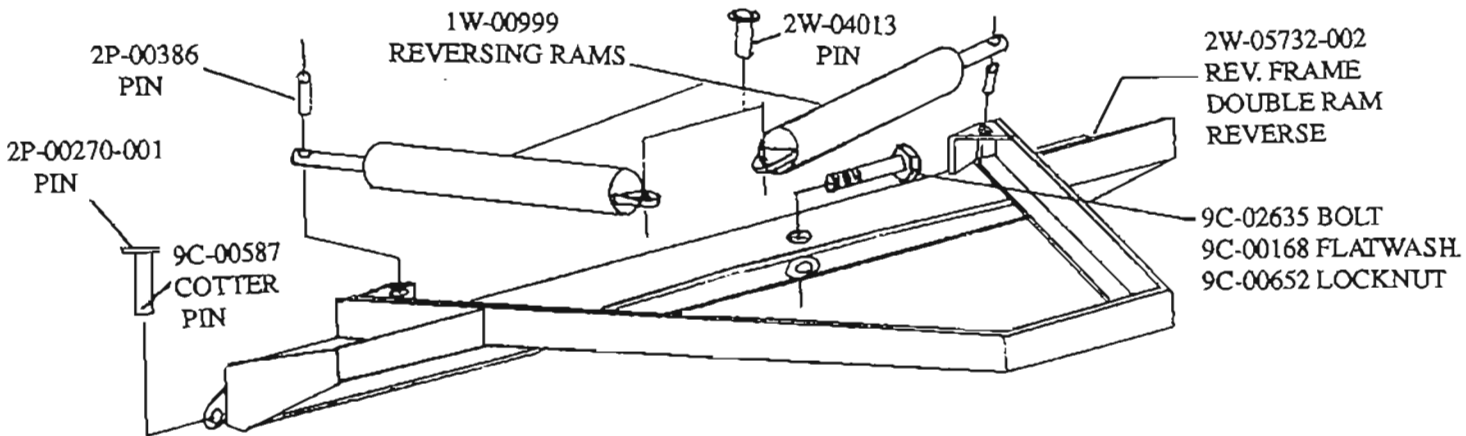
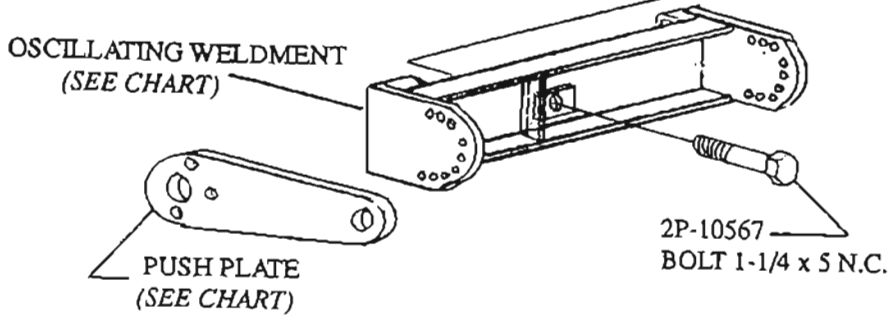

NOTE: When ordering rev. frame for Expressway Plows, order 2W-05732-002 with 2K-04819-001 added.

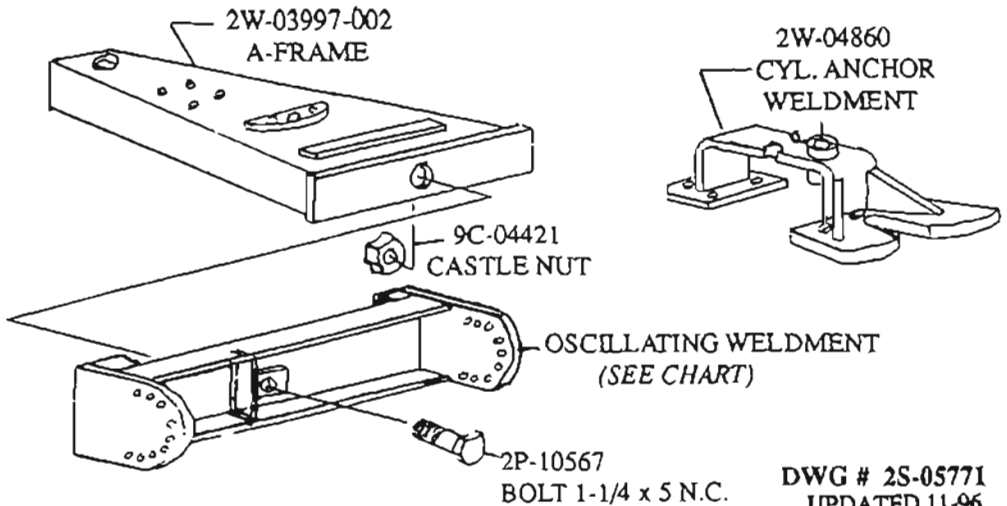

# TB TBA SERIES MOLDBOARD ASSEMBLIES

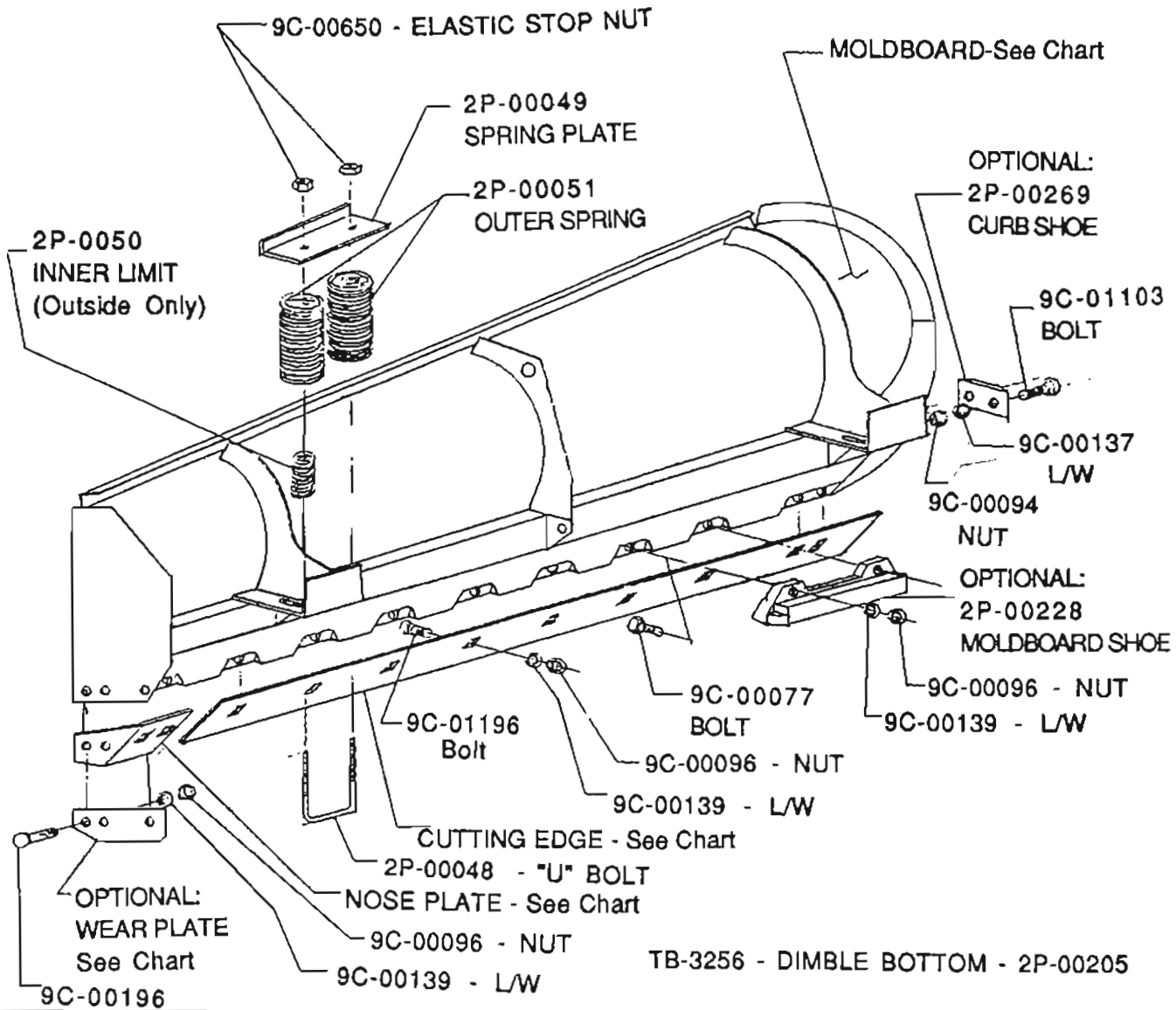

PLOW MODEL	MOLDBOARD PART NUMBER	STANDARD CUTTING EDGE COMPONENTS	STANDARD. CUTTING EDGE COMPONENTS
TB-2846 TBA-2846	2A-00177	1/2 X 6 Cutting Edge - 2P-02066 Nose Plate - 2P-00182 Wear Plate	1/2 X 8 Cutting Edge - 2P-01293 Nose Plate Wear Plate
TB-3050 TBA-3050	2A-00190 2A-00192	1/2 X 6 Cutting Edge - 2P-02066 Nose Plate - 2P-01522 Wear Plate - 2P-00199	1/2 x 8 Cutting Edge - 2P-01293 Nose Plate - 2W-01922 Wear Plate - 2P-01921
TB-3256 TBA-3256	2A-00203	1/2 x 6 Cutting Edge - 2P-02038 Nose Plate - 2P-00201 Wear Plate - 2P-00199	1/2 x 8 Cutting Edge - 2P-01298 Nose Plate - 2P-02003 Wear Plate - 2P-01921
TB-2448 BC	2A-04298	Nose Plate Wear Plate	1/2 x 8 Cutting Edge - 2P-04303 Nose Plate - 2P-00201 Wear Plate - 2P-00199
TB-3050 WYO.	2A-00190	1/2 x 6 Cutting Edge -1. 2P-04668 2. 2P-04667 Nose Plate - 2P-01522 Wear Plate - 2P-00199	

\*ALWAYS SPECIFY MODEL AND SERIAL NUMBER WHEN ORDERING REPAIR PARTS.

DWG.# 2S-02563  
UPDATED 11-96

# "TB" FIXED PUSHFRAME

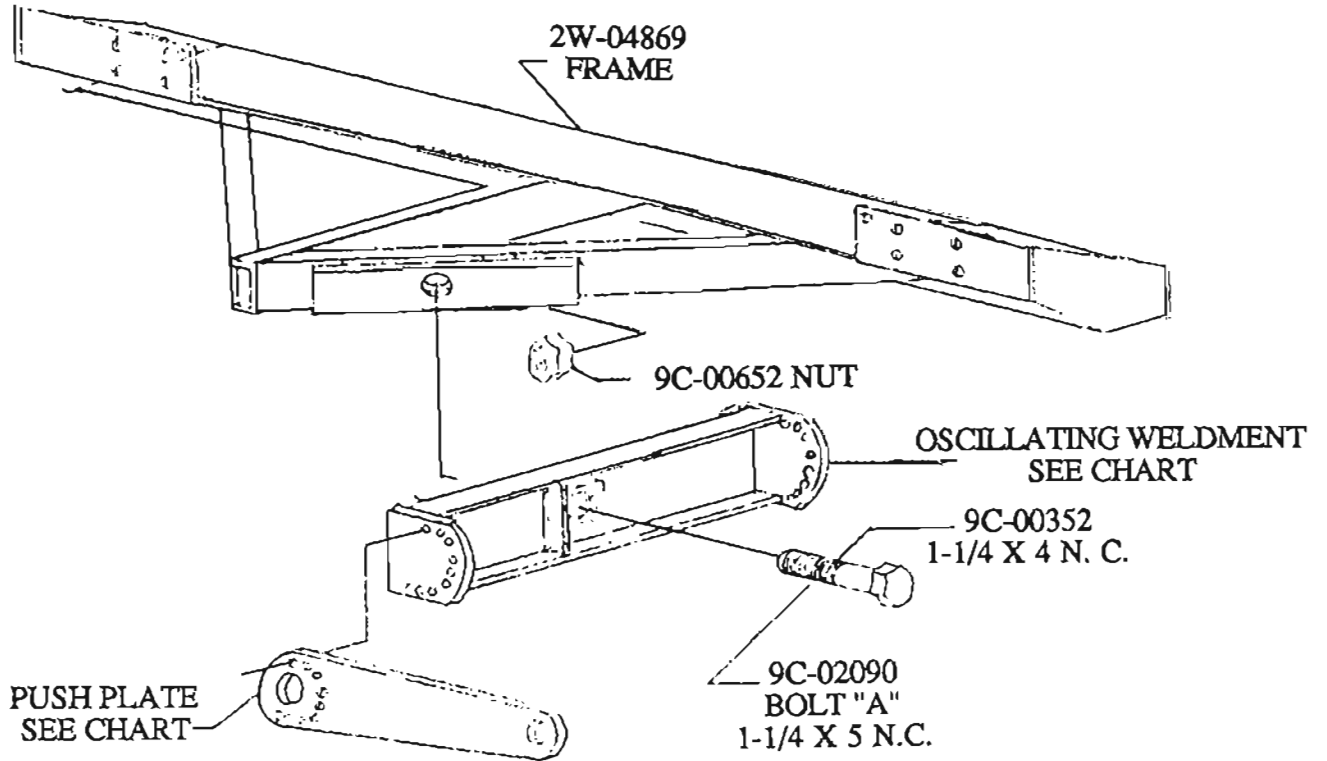

OSCILLATING WELDMENT		
Part Number	Width	
2W-03963	30	Standard
2K-04020	23	Option

PUSH PLATES		
Part Number	Length	
2P-001048	8	Option
2P-01052	13-1/2	Std.
2P-03147	23-1/2	Opt.

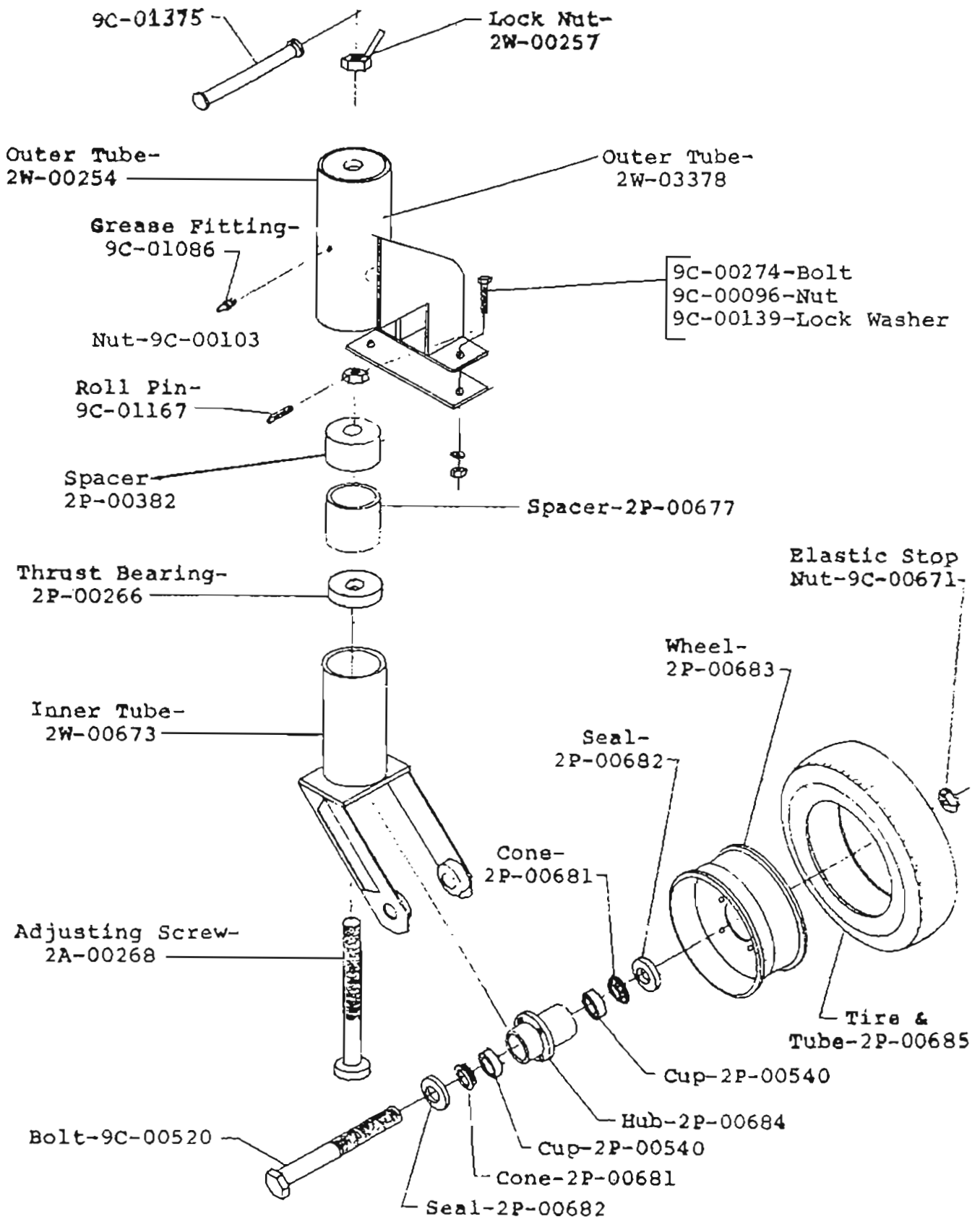

Complete Assembly  
2A-03383

SCREW ADJUSTABLE RUBBER-TIRED CASTER WHEEL- OPTIONAL		
	TPN	10/22 2S-03516

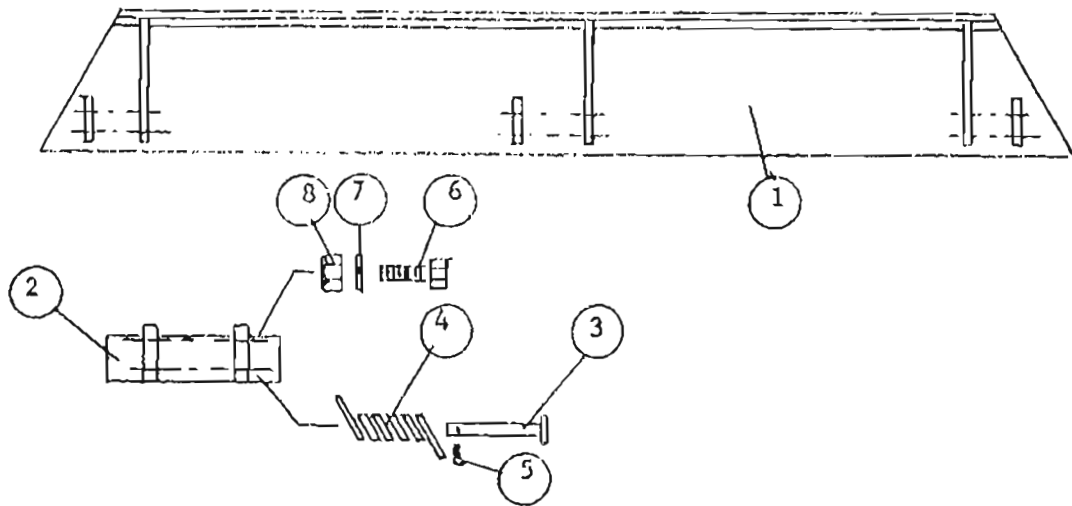

PLOW MODELS		DEFLECTOR KIT	
R-3010	RG - 2886		2K-04739-002
R-3610			
R-4510			
R-3611	RG - 2893	TB -3050	2K-04739-003
R-4511		TBA-3050	
R-4512	RG - 28100	TB -3256	2K-04739-004
		TBA -3256	

PARTS LIST

ITEM	REQ.	PART NUMBER	DESCRIPTION
1	1	2W-04738-002	Moldboard Weldment for 2K-04739-002
1	1	2W-04738-003	Moldboard Weldment for 2K-04739-003
1	1	2W-04738-004	Moldboard Weldment for 2K-04739-004
2	3	2W-04735	Hinge 11'0" Deflector and 10'-0"
2	4	2W-04735	Hinge 12'0" Deflector
3	3	2P-01236-002	Pin - 10'0" & 11'-0" Deflector
3	4	2P-01236-002	Pin - 12'0" Deflector
4	3	2P-00547	Spring - 10'-0" 7 11'-0" Deflector
4	4	2P-00547	Spring - 12'-0" Deflector
5	3	9C-00562	Cotter Pin - 1/8 x 1-1/2 - 10'-0" & 11'
5	4	9C-00562	Cotter Pin - 1/8 x 1-1/2 - 12'-0"
6	3	9C-00424	Bolt - 10'-0" & 11'-0" - Rigid Deflec
6	4	9C-00424	Bolt - 12'-0" Rigid Deflector
7	3	9C-00137	Lockwasher - 10'-0" & 11'-0" Rigid De.
7	4	9C-00137	Lockwasher - 12'-0" Rigid Deflector
8	3	9C-00115	Nut - 10'-0" & 11'-0" Rigid Deflector
8	4	9C-00115	Nut - 12'-0" Rigid Deflector

DEFLECTOR CHART - R, RC, TB, TBA  
SERIES PLOWS

RER

2S-04902

OPTIONAL  
CUTTING EDGE KITS

9C02050  
007

$\frac{1}{2}$ x 8" Cutting Edge Steel	
10' Cut	2P-01293
11' Cut	2P-01298
12' Cut	Not Available

Rubber Cutting Edge	
10' Cut	2K-03405-002
11' Cut	2K-03405-003
12' Cut	2K-03405-004

\*Rubber Cutting Punched on Center w  
Slotted Holes

CARBIDE KITS

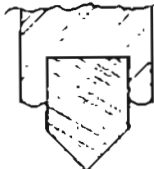

LOG CABIN

Carbide Kit	Size	Description
2K-03483-002	10' Cut	3/4 x 6 Trapezoid
2K-03483-003	11' Cut	3/4 x 6 Trapezoid
2K-03483-004	12' Cut	3/4 x 6 Trapezoid



TRAPEZOID

Kit No.	Size	Description
2K-03930-003	10' Cut	7/8 x 5 Trapezoid
2K-03930-004	11' Cut	7/8 x 5 Trapezoid
2K-03930-005	12' Cut	7/8 x 5 Trapezoid

Kit No.	Size	Description
2K-03931-003	10' Cut	3/4 x 6 Log Cabin
2K-03931-004	11' Cut	3/4 x 6 Log Cabin
2K-03931-005	12' Cut	3/4 x 6 Log Cabin

Part No.	Description	Type
2P-03244	3/4x6x3'	Trapezoid Carbide
2P-03245	3/4x6x4'	Trapezoid Carbide
2P-03928	7/8x5x3'	Trapezoid Carbide
2P-03929	7/8x5x4'	Trapezoid Carbide
2P-02074	3/4x6x3'	Log Cabin Carbide
2P-02075	3/4x6x4'	Log Cabin Carbide
9C-02050-002	1 1/2x10x10'	Rubber
9C-02050-003	1 1/2x10x11'	Rubber
9C-02050-004	1 1/2x10x12'	Rubber

NOTE: Kits listed are complete kits which include all necessary bolts, nuts, and lockwashers to convert plow to Carbide. Plow must have Standard Highway Punching for 3' or 4' Sections.

Tube Weldment  
2W-00223

Nut  
9C-00117

L/W-9C-00139

Bolt  
9C-00449

Nut- 9C-00096

L/W-9C-00139

Mushroom Shoe  
2P-00227

Bolt-9C-01188

Complete Assembly-2A-00222

BOLT ADJUSTING MUSHROOM SHOE

NGM

2S-04904

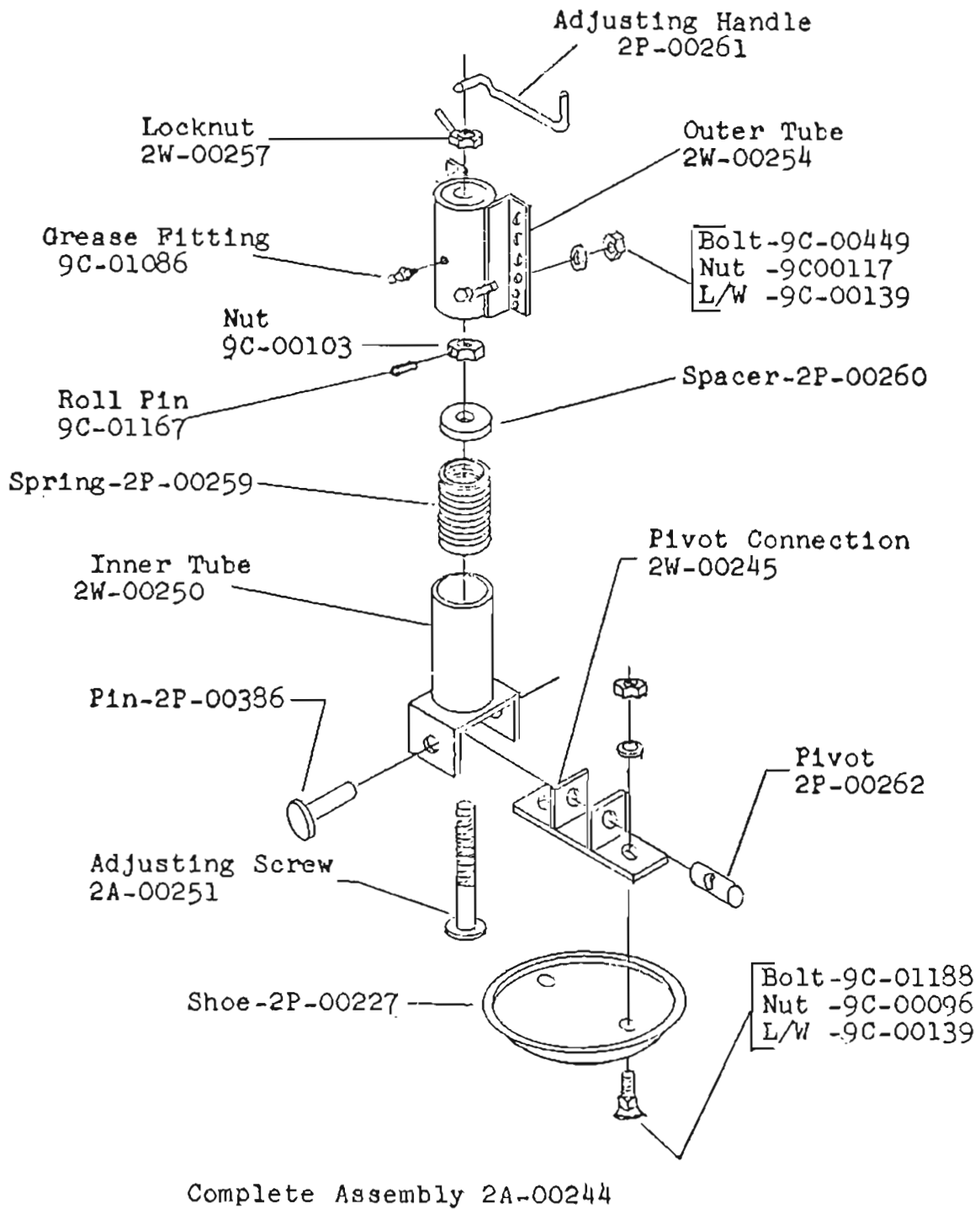



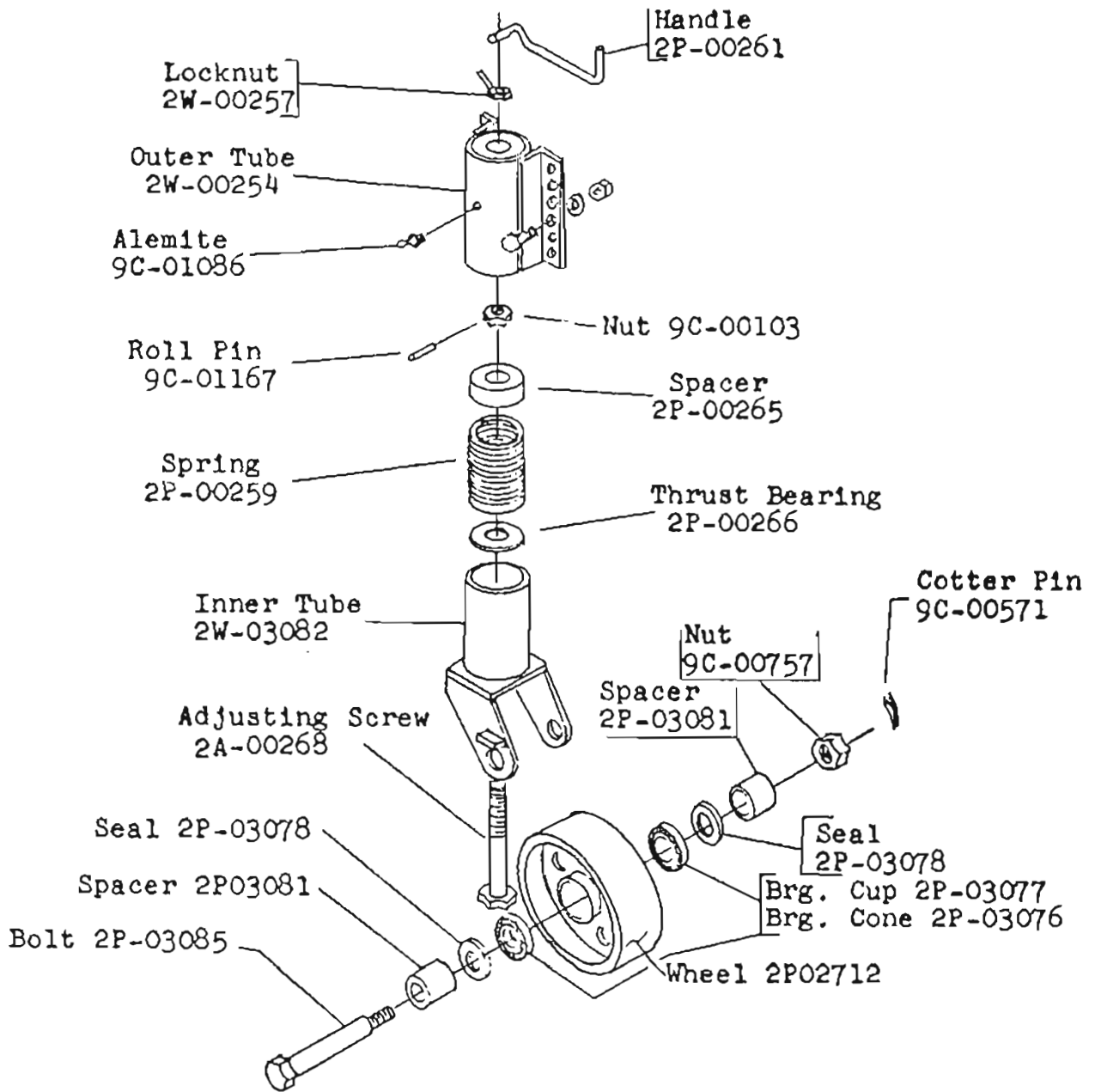

Complete Assembly 10" Caster Wheel 2A-03086

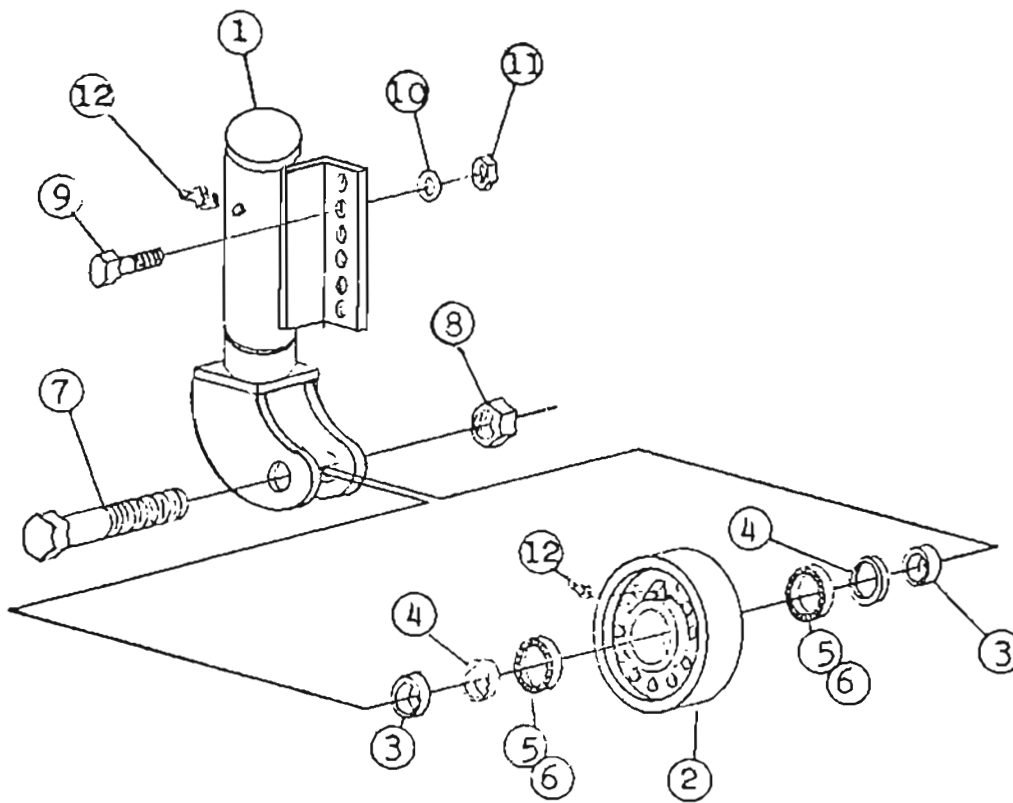

Item No.	Part Number	No. Req'd	Description
1	2W-00229	1	Tube Weldment
2	2P-00241	1	Wheel
3	2P-00237	2	Bushing
4	2P-00238	2	Felt Seal
5	2P-00239	2	Bearing
6	2P00240	2	Race
7	9C-00294	1	Bolt
8	9C-00647	1	Nut
9	9C-00449	4	Bolt
10	9C00139	4	Lockwasher
11	9C-00117	4	Nut
12	9C-01086	2	Alemite

8" Caster Wheel - Cast Iron

NGM

2S-04907

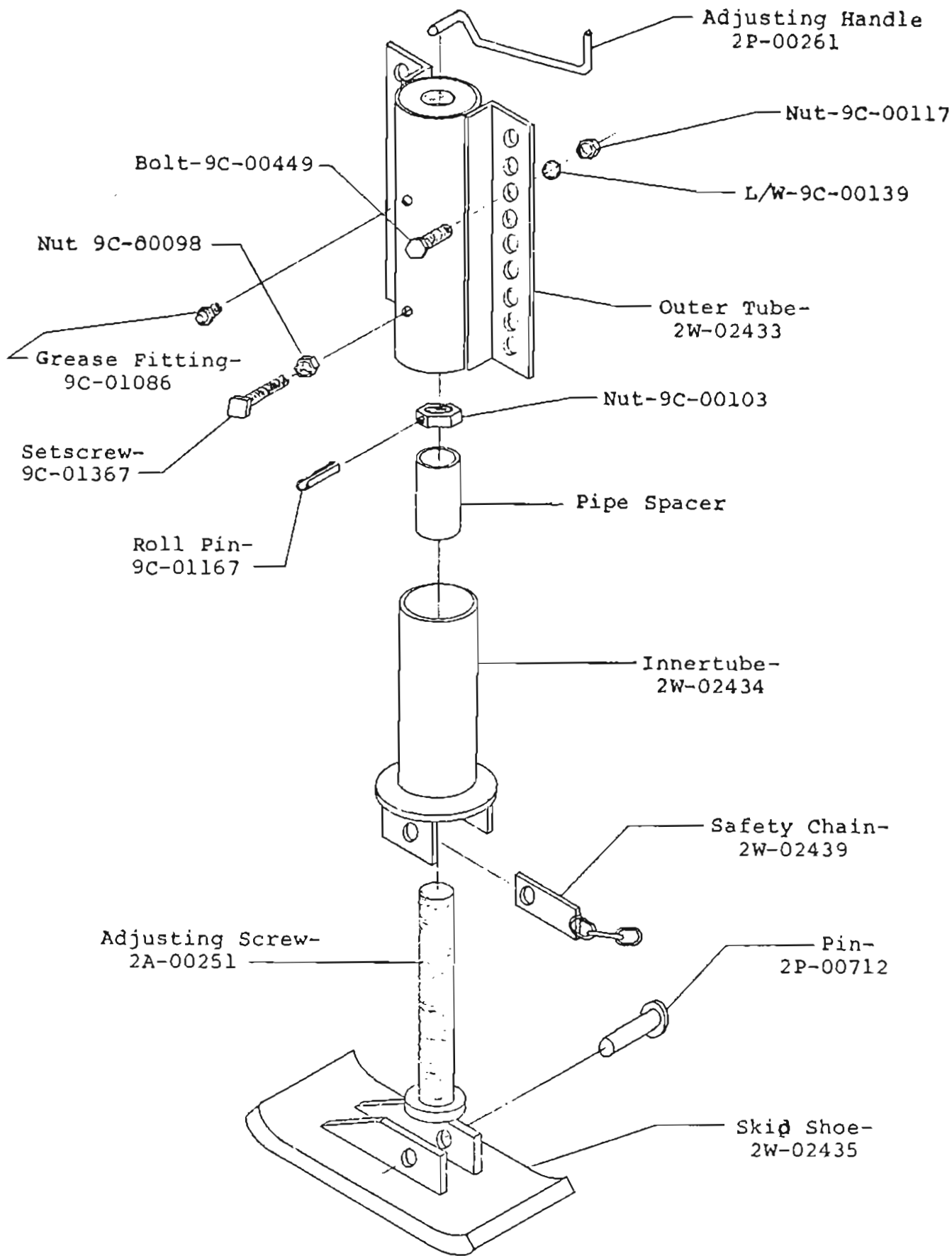

SCREW ADJUSTABLE SKID SHOE - 2A-02432

TPN

2S-02468

STD. CASTER WHEEL & SKID SHOES

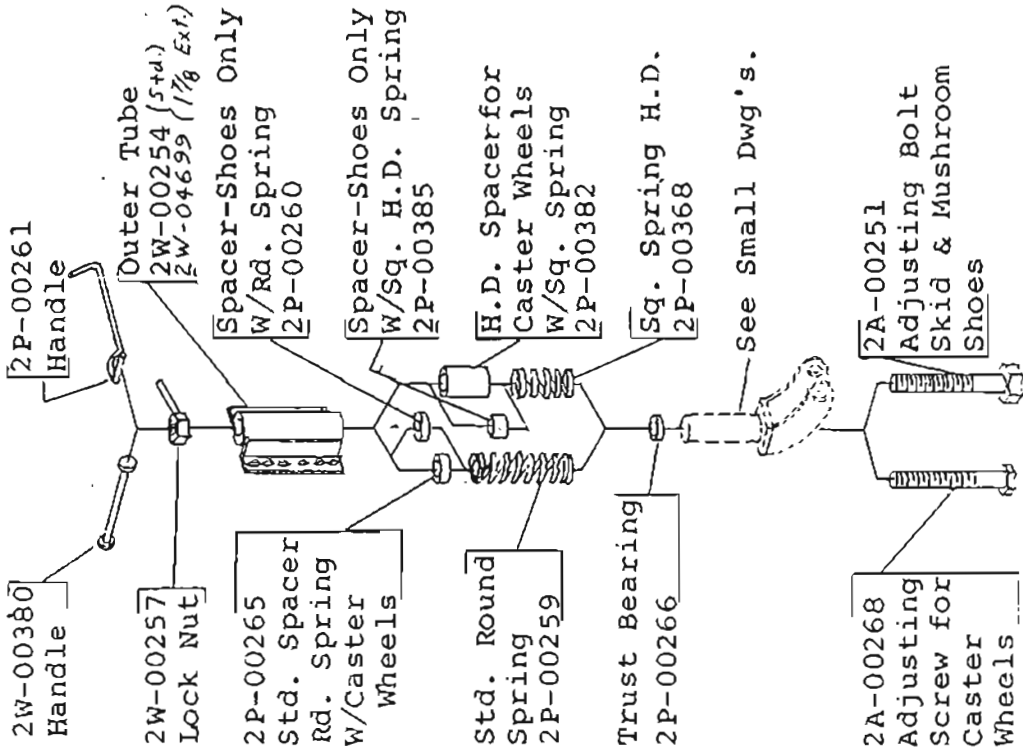

COMMON PARTS

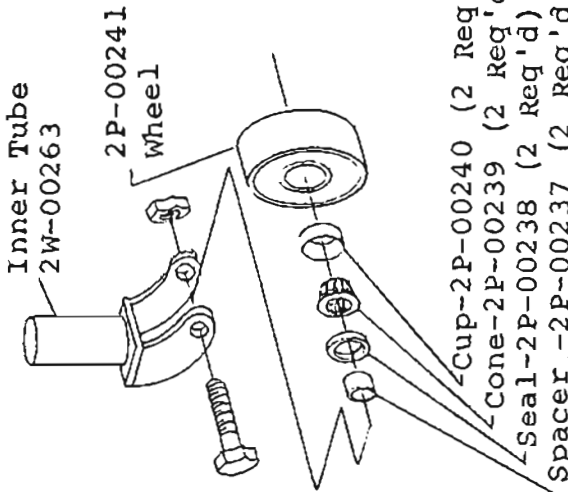

8 x 3 Cast Iron Caster Wheel  
Complete Assembly-2A-00383(HD)  
2A-00267

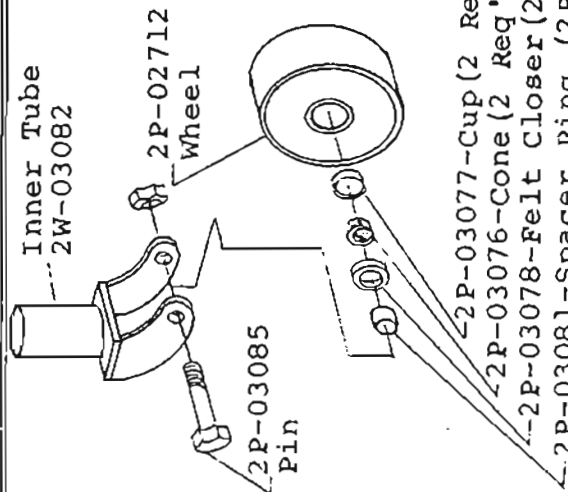

10 x 3-1/4 Cast Iron Wheel  
Comple Assembly-2A-03507(HD)  
2A-03086

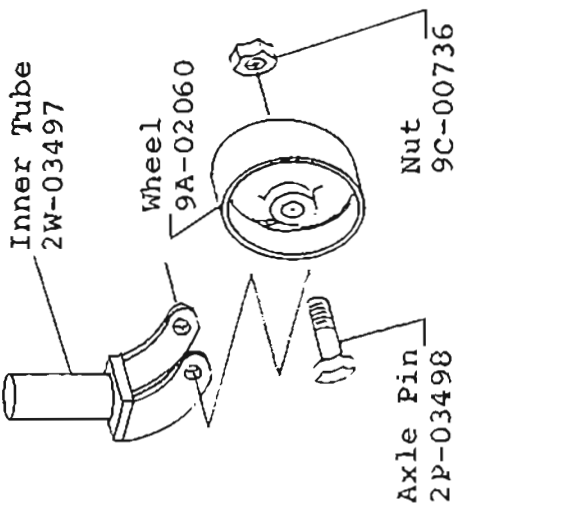

10 x 3 Rubber Wheel  
Complete Assembly 2A-03499  
2A-04490

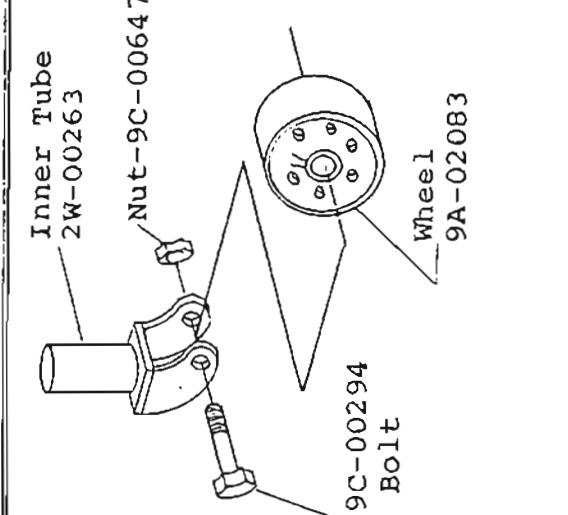

8" x 3" Urethane Wheel  
Complete Assembly  
2A-03497

STD. CASTER WHEELS AND SKID SHOES

NGM

8/4/71

2S-04640

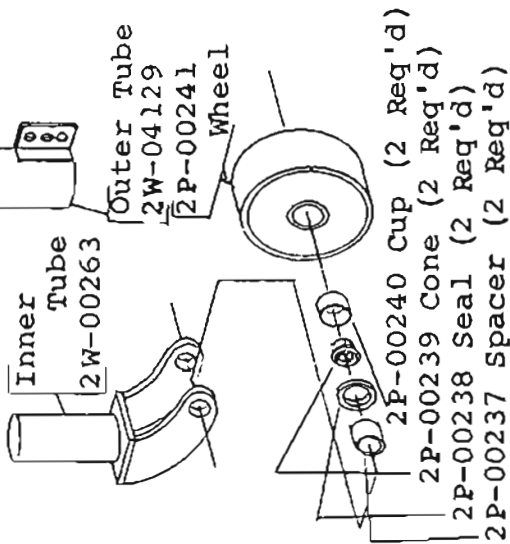

8 x 3 Cast Iron Wheel  
Lyons Special 2A-04130

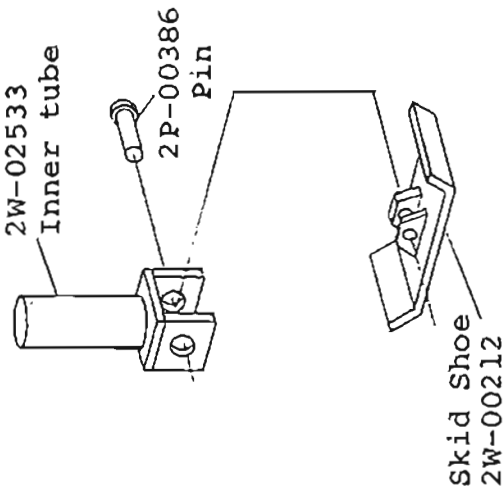

Skid Shoe  
Complete Assembly 2A-02534

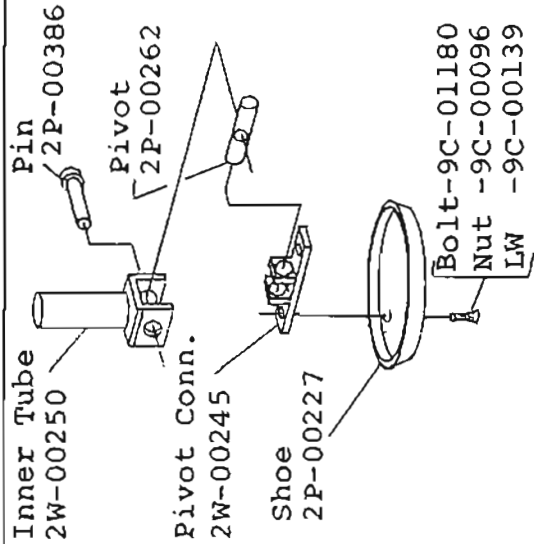

Mushroom Shoe W/HD Sq.Spring  
Complete Assembly 2A-00387

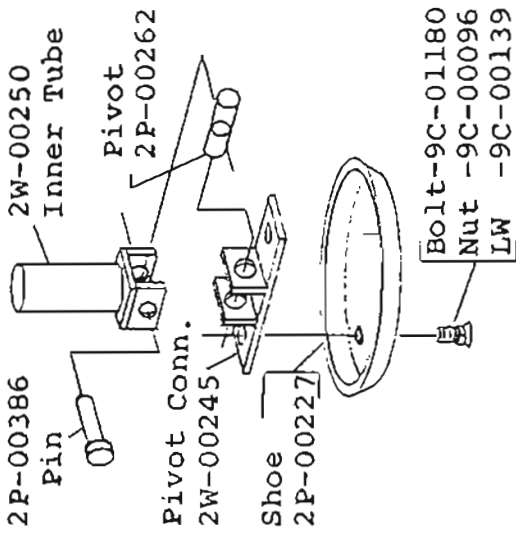

Mushroom Shoe SD  
Complete Assembly 2A-00244

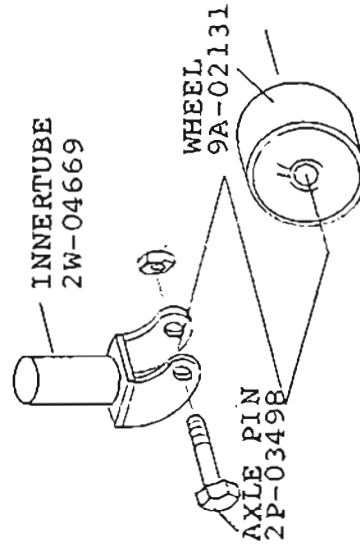

12 x 3 Rubber wheel  
Complete assembly 2A-04670

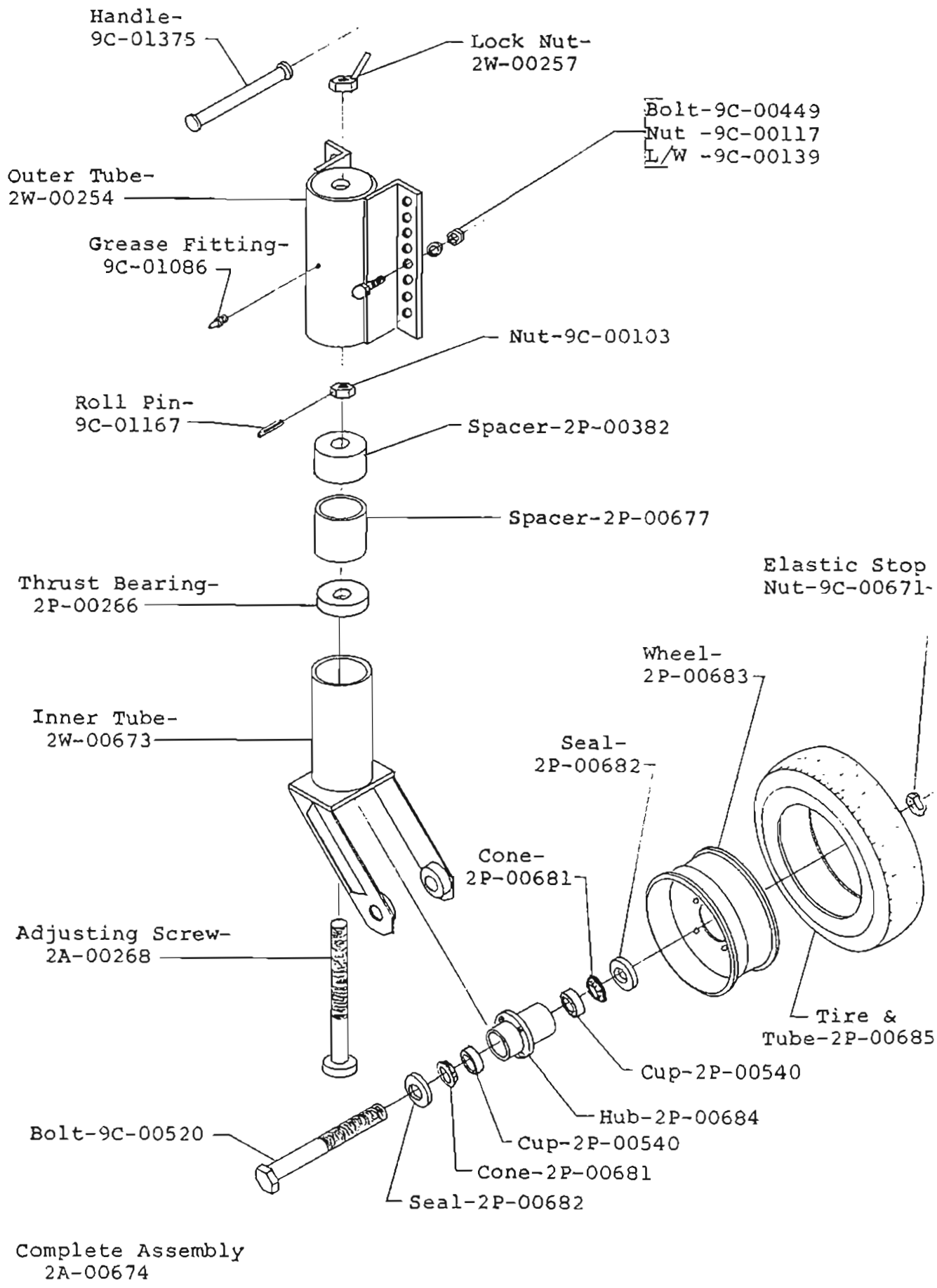

SCREW ADJUSTABLE RUBBER-TIRED CASTER  
 WHEEL- USED ON WR1142RB

TPN	10/22	2S-02560
-----	-------	----------

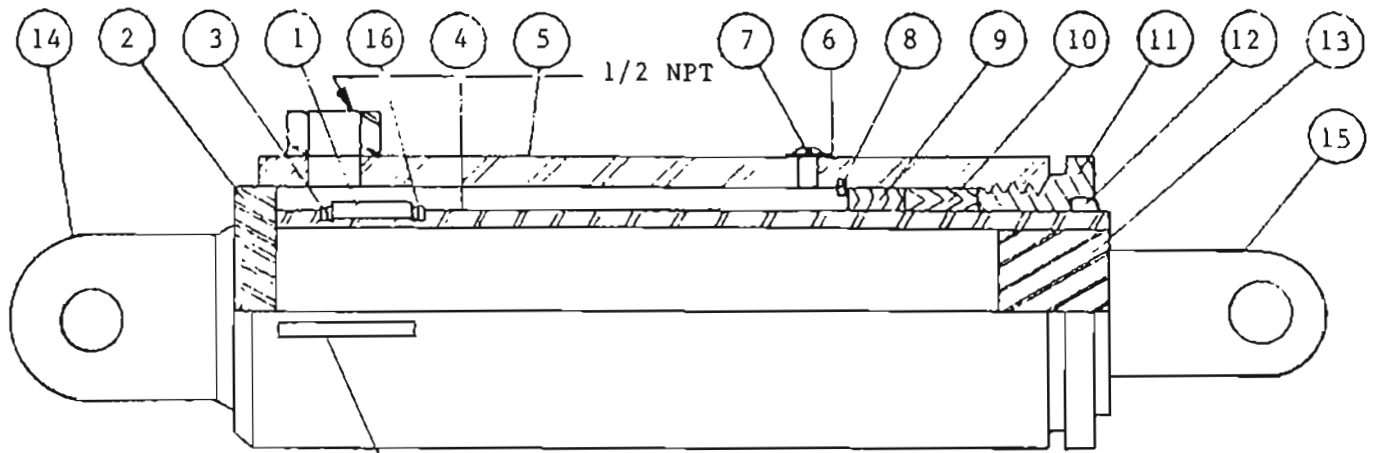

140025B STAMPED ON BASE END OF TUBE OD  
USE PARTS LIST BELOW

ITEM NO.	PART NUMBER	NO. REQ'D.	DESCRIPTION
1	1P-00564	1	PISTON
2	1P-00471	1	BASE PLUG
3	1P-00565	1 *	SNAP RING
4	1P-00566	1	PLUNGER
5	1P-00567	1	CYLINDER
6	1P-00568	1	WASHER
7	1P-00569	1	SCREW
8	1P-00570	1 *	SNAP RING
9	1P-00571	1	ADAPTER
10	1P-00572	1 *	PACKING SET
11	1P-00573	1	GLAND
12	1P-00574	1 *	WIPER
13	1P-00575	1	PLUG
14	1P-00576	1	BASE LUG
15	1P-00577	1	ROD CLEVIS
16	1P-00578	1 *	SNAP RING

\* IN REPAIR KIT FOR ABOVE CYLINDER, ORDER 1K-00847-009

COMPLETE RAM 1A-00116

3-1/2" SINGLE ACTING RAM  
10" STROKE

GNB

3-10-87

1S-01496

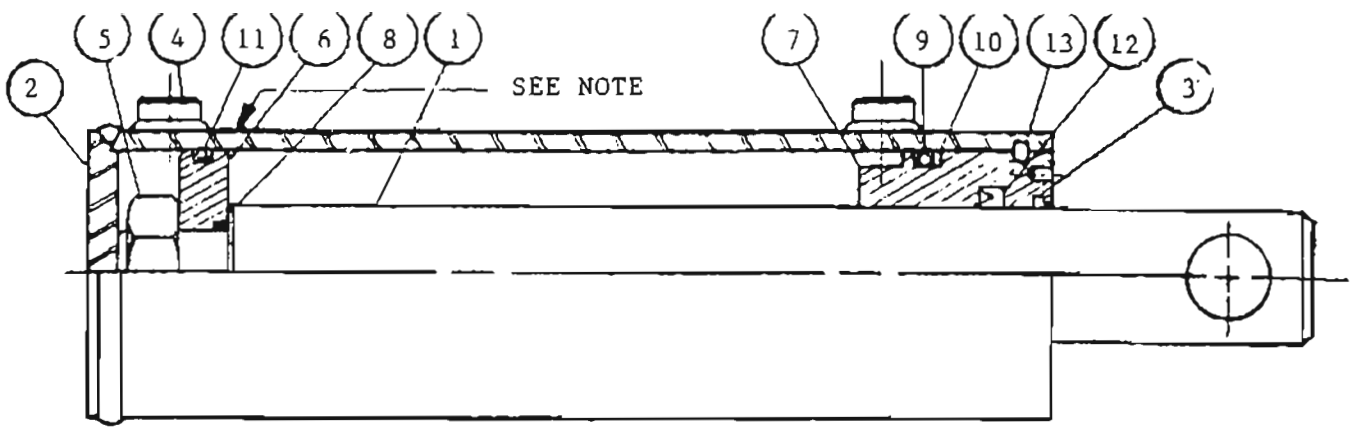

ITEM NO.	PART NUMBER	NO. REQ'D.	DESCRIPTION
1	9C03831	1	PISTON ROD
2	9C03832	1	BARREL ASSY.
3	9C03810	1	WIPER
4	9C03811	2	PORT PLUG (½ NPTF)
5	9C03812	1	LOCKNUT (½-12) ✓
6	9C03813	1	PISTON
7	9C03814	1	GLAND
8	9C03815	1	⊗ O-RING
9	9C03816	1	⊗ O-RING
10	9C03817	1	⊗ BACK-UP WASHER
11	9C03818	1	⊗ CROWN SEAL
12	9C03819	1	⊗ U CUP
13	9C03820	1	⊗ SQ. RING RET.

NOTE: STEEL STAMP AF-536 IN LOCATION SHOWN

⊗ IN REPAIR KIT FOR ABOVE CYINDER, ORDER 1K-00847-018.

" PRINCE "

PARTS DRWG. FOR 1W-00999  
COMPLETE RAM 1A-00998

4" DOUBLE ACTING RAM  
18" STROKE

REVERSE RAM

GNB

2-24-87

1S-01017



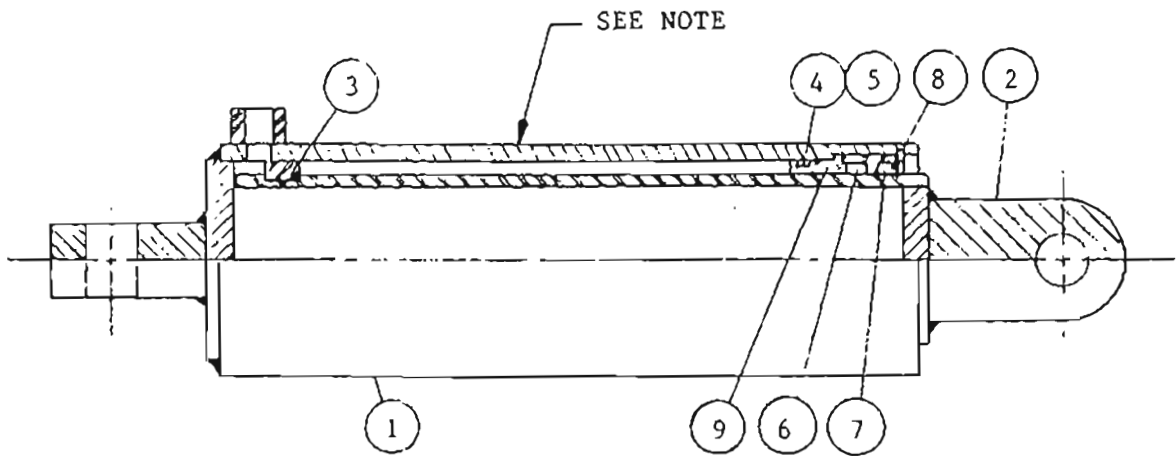

ITEM NO.	PART NUMBER	NO. REQ'D	DESCRIPTION
1	9C03865	1	CYLINDER WELDMENT
2	9C03866	1	ROD
3	9C03867	1	PISTON
4	9C03870	1 ⊕	O-RING
5	9C03871	1 ⊕	BACK-UP RING
6	9C03872	1 ⊕	ROD SEAL
7	9C03873	1 ⊕	ROD WIPER
8	9C03869	1 ⊕	RETAINING RING
9	9C03868	1	GLAND

NOTE: TJB 115 LOCATED ON CYLINDER CENTER LINE BETWEEN THE PORT AND BLEED SCREW. USE PARTS LIST ABOVE.

⊕ IN REPAIR KIT FOR ABOVE CYLINDER ORDER 1K-00847-022.

COMPLETE RAM 1A00115

2-1/2" X 10" SINGLE ACTING CYLINDER

GNB 3-10-87 1S-01497

## 6. Torque specification chart

### SAE Grade 8 Bolts

<u>Coarse thread</u>	<u>Max. torque dry (Lbs./Ft.)</u>	<u>Fine thread</u>	<u>Max. torque dry (Lbs./Ft.)</u>
5/16. . . . .	25	5/16. . . . .	25
3/8 . . . . .	45	3/8. . . . .	50
7/16. . . . .	70	7/16. . . . .	80
1/2 . . . . .	110	1/2. . . . .	120
9/16. . . . .	150	9/16. . . . .	170
5/8 . . . . .	220	5/8 . . . . .	240
3/4 . . . . .	380	3/4 . . . . .	420
7/8 . . . . .	600	7/8. . . . .	660
1 . . . . .	900	1 . . . . .	1,000
1-1/8 . . . . .	1,280	1-1/8. . . . .	1,440
1-1/4 . . . . .	1,820	1-1/4 . . . . .	2,000
1-3/8 . . . . .	2,380	1-3/8. . . . .	2,720
1-1/2 . . . . .	3,160	1-1/2. . . . .	3,560

### BOLT HEAD IDENTIFICATION

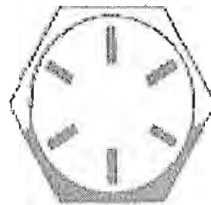

KEEPING AHEAD OF THE CUTTING EDGE™

## 7. WARRANTY POLICY

### SECTION 1 - DEFINITION OF WARRANTY POLICY

Schmidt Engineering & Equipment, Inc. (herein called "SEE") warrants its products to be free of defects in material and workmanship under normal use and service for a period of one year from the date of final acceptance.

### SECTION 2 - COVERAGE

This warranty covers all products sold by Schmidt Engineering & Equipment, Inc.

### SECTION 3 - OBLIGATIONS OF SCHMIDT

SEE's obligation under this warranty is limited to repairing and replacing, at SEE's option, any parts which prove defective. This warranty does not cover travel time, mileage, out-of-pocket expenses or other related expenses to repair SEE products unless approved in writing. The warranty also does not cover "premium time" incurred by the customer.

This warranty does not apply to any product which has been subjected to misuse, negligence, or operation not in accordance with written operating instructions.

SEE accepts no responsibility for unauthorized repairs or modifications. All modifications must be approved in writing by our Service or Engineering departments during the warranty period.

### SECTION 4 - PROCEDURES FOR FILING WARRANTY CLAIMS

The following procedures for filing a warranty claim must be followed exactly, or the warranty claim will be deemed void.

A. Any claim for parts and labor exceeding \$500.00 will require an ADVANCE WARRANTY AUTHORIZATION NUMBER, to be assigned by SEE's Service department. This number, along with SEE's authorization will be documented on the ADVANCE WARRANTY AUTHORIZATION FORM. A copy of this form will be forwarded to the customer and will serve as a limited agreement until a warranty claim has been filed, approved and processed. SEE accepts no responsibility and will not make reimbursements for repairs made prior to the claimant's receipt of this form.

B. The ADVANCE WARRANTY AUTHORIZATION FORM will also specify a maximum dollar limit for authorized parts and labor. SEE accepts no responsibility and will not make reimbursements for repairs which exceed the maximum authorized dollar limit on this form.

C. All warranty claims must be submitted to SEE on SEE's standard WARRANTY CLAIM FORM. SEE accepts no responsibility and will not make reimbursements for claims which are not submitted on SEE's standard form. Claim forms which are incomplete will not be processed.

D. All claims for warranty must be received by us within 30 days of completion of work or authorization. Claims made later than 30 days after warranty expiration will not be honored. SEE will process warranty claims within 30 days after receipt of SEE's

KEEPING AHEAD OF THE CUTTING EDGE™

standard WARRANTY CLAIM FORM, or within five (5) working days after SEE has been reimbursed from a third party vendor, if applicable, whichever is later.

E. WARRANTY CLAIM FORMS SUBMITTED WILL BE REVIEWED BY SEE'S SERVICE DEPARTMENT. UPON AUTHORIZATION OF THE WARRANTY CLAIM FORM BY SEE'S SERVICE DEPARTMENT, A CREDIT MEMO WILL BE ISSUED AND APPLIED AGAINST CURRENT OUTSTANDING INVOICES OR, IF THERE ARE NO CURRENT OUTSTANDING INVOICES, A CHECK WILL BE ISSUED FOR THE APPROVED WARRANTY CLAIM.

A WARRANTY CLAIM SUBMITTED TO SEE WITHIN THE REQUIRED TIME-FRAME IS AN APPLICATION FOR WARRANTY REIMBURSEMENT. A PENDING POTENTIAL WARRANTY CLAIM DOES NOT, UNDER ANY CIRCUMSTANCES, PRECLUDE PAYMENT OF THE INVOICE IN FULL WHEN DUE. ANY WARRANTY CLAIM DEDUCTED FROM A PAYMENT PRIOR TO THE ISSUANCE OF A CREDIT MEMO WILL DEEM THE WARRANTY CLAIM VOID, AND FULL PAYMENT WILL BE DEMANDED.

IF ANY PORTION OF A CUSTOMER'S ACCOUNT BALANCE IS PAST DUE, WARRANTY CLAIMS WILL NOT BE HONORED, NOR SHALL THE CUSTOMER RECEIVE SERVICE OR SUPPORT OF ANY KIND UNTIL ALL PAST DUE BALANCES HAVE BEEN PAID.

#### SECTION 5 - OTHER

At the discretion of SEE, defective parts must be held for inspection by our field personnel, or shipped prepaid to SEE in New Berlin, Wisconsin. Claims for parts must be accompanied by a copy of the original invoice. Any claims against SEE for shipment shortages shall be deemed waived unless made in writing by the purchaser within ten (10) days of shipment from the factory. Such claims shall be submitted in suitable form and detail to enable SEE to file a claim with the carrier, if appropriate. SEE's responsibility of shipment ceases upon delivery to a carrier and any claims for delay or damages known to occur thereafter shall be made by the dealer/customer direct to the carrier.

**THIS IS THE ONLY WARRANTY GIVEN WITH THE PURCHASE OF A SEE PRODUCT. ANY WARRANTIES IMPLIED BY LAW ARE LIMITED TO 12 MONTHS FROM THE DATE OF INITIAL OPERATION. SEE NEITHER ASSUMES NOR AUTHORIZES ANY OTHER PERSON TO ASSUME FOR THEM ANY OTHER LIABILITY IN CONNECTION WITH SUCH PRODUCTS. NO PAYMENT OR OTHER COMPENSATIONS WILL BE MADE FOR INDIRECT OR CONSEQUENTIAL DAMAGES SUCH AS DAMAGE OR INJURY TO PERSON OR PROPERTY OR LOSS OF REVENUE WHICH MIGHT BE PAID, OR OTHER COMMERCIAL LOSSES INCURRED DUE TO THE REPRESENTATION OF THIS WARRANTY, INCURRED OR SUSTAINED BY REASON OF THE FAILURE OF ANY PART OF ASSEMBLY WHICH MIGHT BE REPAIRED OR REPLACED IN ACCORDANCE WITH THE TERMS OF THIS WARRANTY. FURTHERMORE, THERE ARE NO OTHER WARRANTIES EXPRESSED OR IMPLIED OR OF MERCHANTABILITY OR FITNESS FOR ANY PARTICULAR PURPOSES AND OF ANY NON CONTRACTUAL LIABILITIES, INCLUDING PRODUCT LIABILITIES BASED UPON NEGLIGENCE OR STRICT LIABILITY.**

KEEPING AHEAD OF THE CUTTING EDGE™